

4K HDR 4:4:4 60Hz HDBaseT™ Extender with DSC Supporting USB.2.0 Client/host (4K: 100m/328ft)

EX-100-H2-PRO

WyreStorm

Specification Sheet

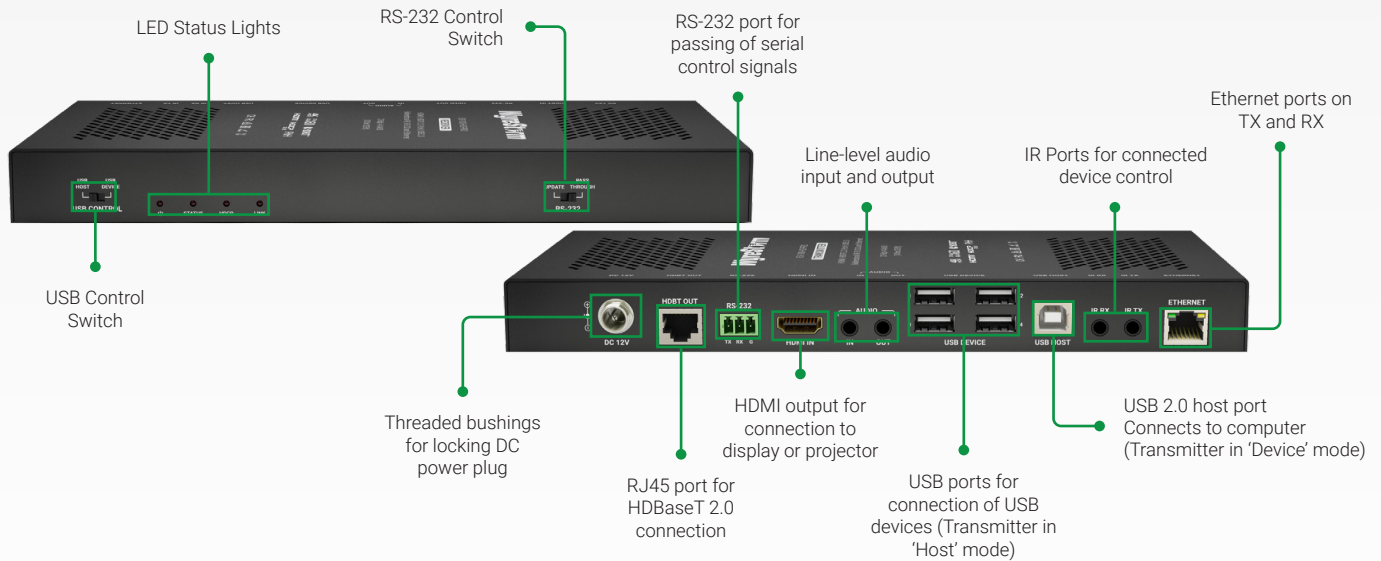

WyreStorm - Powerful. Reliable. Simple.

Introduction

Utilizing the best in HDBaseT technology, the EX-100-H2-PRO uses the powerful 2.0 chipset for 5-Play functionality: 4K HDMI, USB, Ethernet, Control and Power over 100m/328ft of Cat 6 cable. Using DSC (display stream compression) the EX-100-H2-PRO can support HDMI video up to 2160p 4:4:4 at 60Hz (18Gbps) without any visual loss in quality or latency. With HID's and data transfer in mind, the EX-100-H2-PRO supports USB 2.0 devices at up to 480Mbps, catering for powerful webcams, smart whiteboards and flash drives alike. Also included is a dedicated 2-way audio lane for transmission of analog stereo audio signals from TX-RX and RX-TX.

Key Features

- Point-to-point HDBaseT Extender supporting:
 - Content up to 4K/60 4:4:4 & RGB 8-bit
 - The latest HDR standards, including HDR-10, HLG and Dolby Vision at 30Hz
 - HDCP 2.2 encryption technology ensuring compatibility with the latest 4K UHD content and sources
 - HD Multichannel audio up to DTS:X and Dolby Atmos to all outputs
- Extends 2160p 4:4:4 or 4:2:2 12-bit HDR content from a source to a display or projector using HDBaseT up to 100m/328ft
- Automatically activated DSC lossless compression handles HDMI content up to 17.8Gbps
- HDMI Input and HDMI output supports bandwidths of up to 18Gbps
- Compatible with DVI-I and DP++ v1.3 signals from compatible devices
- Bidirectional USB 2.0 passthrough offering 480Mbps transfer and HID extension, with host and 4 device ports on both TX and RX
- 10/100 Ethernet port on both ends for extension of LAN to TX or RX
- Bidirectional audio lane separate to HDMI signal sends and receives analog audio signals at either end
- Bidirectional IR, RS-232 and CEC communication
- DIP Switch selection for direction of USB control, long cable mode and firmware update
- Backwards compatible with HDBaseT™ 1.0 transmission and receiving devices (lowest denominator takes priority)
- LED indication for power supply to units, signal status to show established display connection, HDCP presence in signal and transmission link
- 1-way PoH (Power over HDBaseT™) enables the receiver to be remotely powered by the transmitter
- Locking DC power jacks
- 12v DC PSU with US, UK, EU & AU Power cables included
- Mounting brackets included

In the Box

1x EX-100-H2-PRO Transmitter (TX)
1x EX-100-H2-PRO Receiver (RX)
1x IR Emitter
1x IR Receiver

2x 3-pin Terminal Block
4x Mounting Brackets
1x Quickstart Guide
1x 12V DC 3A Power Supply (US/UK/EU/AU)

Specifications

| Audio and Video | | | | |
|--------------------------------------|---|---|-------------|----------------|
| | Transmitter | Receiver | | |
| Inputs | 1x HDMI In: 19-pin type A 1x Audio In: 3.5mm (1/8in) TRS Stereo | 1x HDBT In: 8-pin RJ-45 Female 1x Audio In: 3.5mm (1/8in) TRS Stereo | | |
| Outputs | 1x HDBT Out: 8-pin RJ-45 Female 1x Audio Out: 3.5mm (1/8in) TRS Stereo | 1x HDMI Out: 19-pin type A 1x Audio Out: 3.5mm (1/8in) TRS Stereo | | |
| Output Video Encoding | HDBaseT Class C | | | |
| Encoding Data Rate | 10.2Gbps | | | |
| End to End Latency | 10µs (micro seconds) | | | |
| Audio Formats | 2ch Analog/PCM Multichannel: LPCM up to DTS-X and Dolby Atmos | | | |
| Video Resolutions (Max) | Video Resolution | HDMI | Cat6 | Cat6a/7 |
| | 1920x1080p @120Hz 12bit | 70m/230ft | 70m/230ft | 100m/328ft |
| | 1920x1080p @60Hz 12bit | 15m/49ft | 100m/328ft | 100m/328ft |
| | 3840x2160p @24Hz 10bit 4:2:0 HDR | 15m/49ft | 100m/328ft | 100m/328ft |
| | 3840x2160p @60Hz 8bit 4:4:4 | 7m/23ft | 70m/230ft | 100m/328ft |
| | 3840x2160p @60Hz 10bit 4:2:0 HDR | 5m/16ft | 70m/230ft | 100m/328ft |
| | 3840x2160p @60Hz 12bit 4:2:2 HDR | 5m/16ft | 70m/230ft | 100m/328ft |
| | Note: WyreStorm recommends the use of shielded category cable to minimize signal noise and interference. | | | |
| Supported Standards | DCI RGB HDR HDR10 Dolby Vision up to 30Hz HLG BT.2020 BT.2100 | | | |
| Maximum Pixel Clock | HDMI: 600MHz HDBaseT: 340MHz | | | |
| Communication and Control | | | | |
| HDMI | HDMI HDCP 2.2 EDID CEC Pass-through DVI/D supported with adapter (not included) DP++ | | | |
| HDBaseT | HDMI HDCP 2.2 EDID Audio 1-way PoH (TX powers RX) Bidirectional IR/RS-232/Ethernet CEC | | | |
| Ethernet | 1x Ethernet: 8-pin RJ-45 Female Bidirectional over HDBaseT | | | |
| IR | 1x IR RX: 3.5mm (1/8in) TRS Stereo 1x IR TX: 3.5mm (1/8in) TS Mono (Transmitter and Receiver) | | | |
| RS-232 | 1x RS-232: 3-pin Phoenix (Transmitter and Receiver) | | | |
| USB | 1x Type B (host) 4x Type A (device) (Transmitter and Receiver) USB direction must be set using switch on both transmitter and receiver USB hub compatible Maximum: 7 devices, 23 endpoints Maximum uplink speed: 190Mbps | | | |
| Power | | | | |
| Power Supply | 12V DC 3A | | | |
| Max Power Consumption | 8.88W | | | |
| Environmental | | | | |
| Operating Temperature | 32°F ~ 113°F (0°C ~ 45°C) 10% ~ 90%, non-condensing | | | |
| Storage Temperature | -4°F to ~ 158°F (-20°C ~ +70°C) 10% ~ 90%, non-condensing | | | |
| Maximum BTU | 30.30 BTU/hr | | | |
| Dimensions and Weight | | | | |
| Rack Units Wall Box | <1U | | | |
| Height With Without Feet | 21mm/0.83in | | | |
| Width With Without Brackets | 195mm/7.68in | | | |
| Depth With Without Handles | 94.8mm/3.74in | | | |
| Weight | 0.36kg/0.79lbs | | | |
| Regulatory | | | | |
| Safety and Emission | CE FCC RCM EAC RoHS | | | |

Right Product for the Right Application.

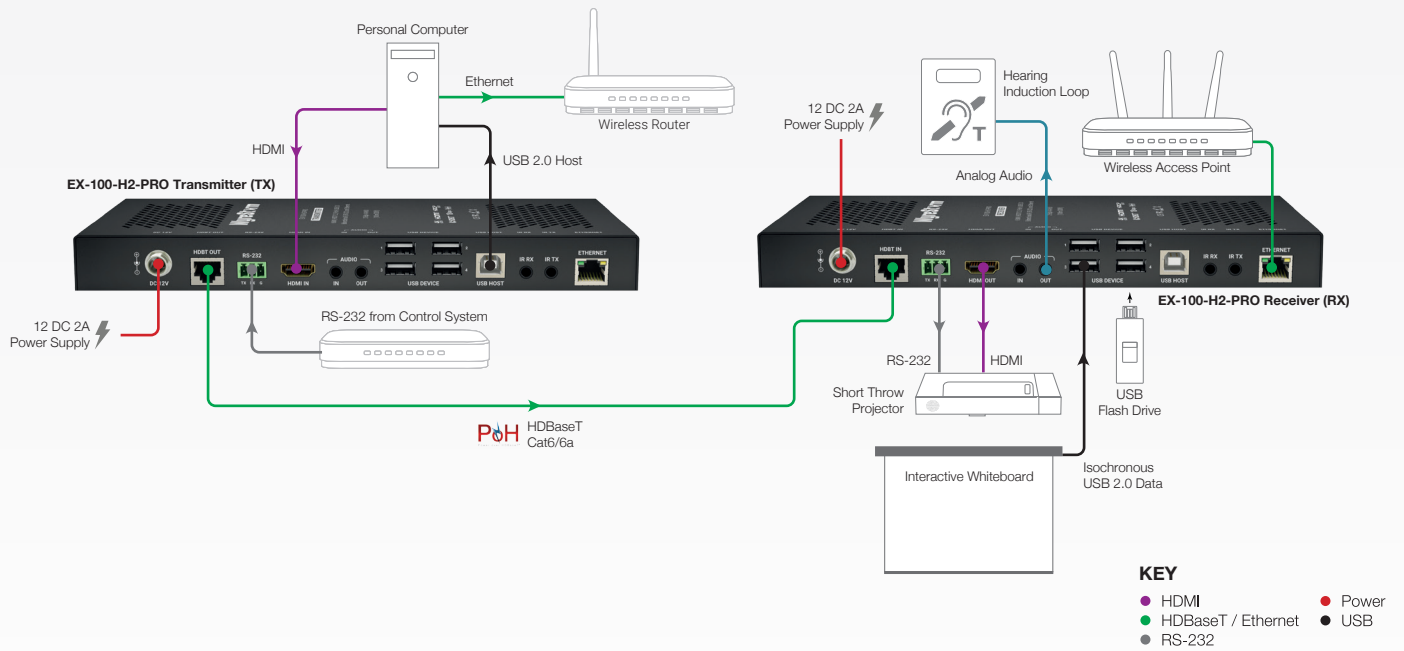

Note: WyreStorm reserves the right to change product specification, appearance or dimensions of this product at any time without prior notice.