

HARVEY®

Control center for audio, light and media equipment

Flexible number of analog audio channels from 0 up to 32

Excellent audio quality with minimal, constant latency

Simple configuration of distributed installations with Hypermatrix®

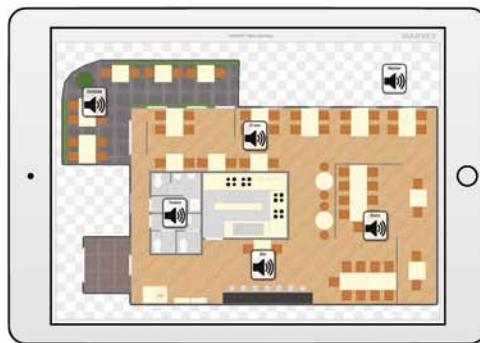

HARVEY is a family of flexible audio and media control matrices and key component for PA and conference systems.

The **HARVEY Pro** product line is equipped with up to 32 analog audio input or output channels as well as a large number of different control interfaces. The unit has extensive audio processing functions that can be configured in a way that is tailored precisely to the respective application. These settings can also be saved in presets and retrieved at the press of a button so that you can change quickly between different installation options. Due to the varied control interfaces HARVEY Pro can connect to very different devices and act as the central control unit for audio, lighting and media technology.

FAMILY MEMBERS

HARVEY Pro is available in different configurations regarding the number of analog IO channels. The table shows the current offering. Please note, that variants 0×N and N×0 require the Dante option. Other interfaces like AES/EBU and class-D amplifier are also available.

It converts the data between the interfaces and eliminates the need for additional converters. All established media control systems are suitable for controlling HARVEY and all other devices connected to it. Furthermore HARVEY features the ability to be controlled by modern web browsers. For that purpose the web interface can be generated with a single click and adjusted by the user without any programming knowledge.

As such, HARVEY is the ideal audio and media control matrix for conference rooms, theatres, museums, home cinemas, educational facilities, and multipurpose rooms.

HARVEY Pro		Analog outputs			
		0	8	16	24
Analog Inputs	0	0×0	0×8	0×16	0×24
	4	4×0	4×8	4×16	4×24
	8	8×0	8×8	8×16	8×24
	12	12×0	12×8	12×16	–
	16	16×0	16×8	16×16	–
	20	20×0	20×8	–	–
24	24×0	24×8	–	–	



Example device: HARVEY Pro 8×8-DA-AMP4

INTERFACES

Audio Inputs: Each input can be configured by software as line level input or as microphone level input. Inputs are equipped with software controllable 48 V phantom power (P48).

Audio Outputs: Analog balanced line level outputs, e.g. for driving amplifiers inputs.

Dante: Optionally available; for connecting several HARVEY units and exchanging digital audio streams among the units and other Dante devices via an Ethernet network.

Class-D amplifiers: 4/8/12-channel Class-D amplifier unit capable of driving up to 12 passive loudspeakers directly with a total of 80 watts (RMS).

Ethernet: Connection to configuration PC as well as other controlling devices or devices to be controlled.

RS232, RS485/DMX512: Interfaces for remote control and exchange of control commands of HARVEY units and external devices, e.g. lighting installations, PA systems, media technology or operating panels.

Digital Control Inputs: 4 logic inputs for switching and controlling presets and binary parameters, e.g. muting channels with external tactile switches.

Analog Control Inputs: 2 analog inputs to externally control HARVEY parameters, e.g. level by potentiometer.

Digital Control Outputs: 4 logic outputs for the control of external devices, e.g. relays or LEDs.

Relay Outputs: 2 outputs for galvanically isolated control output of external devices.

SOFTWARE

SOFTWARE HARVEY Composer, the configuration software of the HARVEY family, has a very user-friendly design and allows you to configure complex projects with only a few mouse clicks. Blocks, that represent the audio signal processing and control functions, are positioned on the worksheet using drag & drop. With only one movement of your mouse multiple channels can be connected, while the number of channels is adjusted automatically. Independent of the number of physical connections, individual connections are combined into clear bundles.

Signal processing functions such as EQ, level display or ducker and many others can be added to the installation simply by drag & drop and configured online. Mixing and switching matrices are also available and can be parameterized freely.

In addition to the audio layer, there is also a control layer. Incoming control signals are evaluated here, linked logically and brought to the audio block control inputs. Presets allow you to switch conveniently between very different use cases. HARVEY fades softly between the presets with configurable fade time per parameter.

With **Hypermatrix®** you can configure as many HARVEY devices as you want on a network as if they were just one single system. The Hypermatrix software always ensures that audio signals and control commands arrive at the right place at the right time.

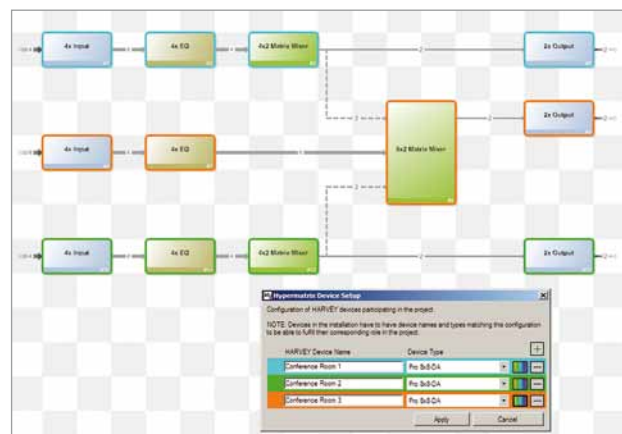

AUDIO PROCESSING

Level, Mixer	Mixing matrix
	Mixing matrix with crosspoint delay
	Automatic mixer
	Level control
	Level meter
	Mute
Equalizer	Ducker
	8-Band parametric equalizer
	Filter (highpass, lowpass, hi-shelf, lo-shelf)
Dynamics	Compressor
	Limiter
	Expander
	Noise Gate
	Automatic Volume Control (AVC)
	Automatic Gain Control (AGC)
Delay	Delay-up to 1000 ms for each delay block

CONTROL

I/O Interfaces	RS 485 DMX, RS 232
	TCP/IP, UDP/IP
	Contacts, Voltage
Protocols	Proprietary (binary, text based) User defined messages
Control Events (triggered by)	Presets
	Thresholds (Level, DMX)
	Input Contacts, Messages
	Block states (e.g. Ducker) Flip-flops
Control Events (can trigger)	Presets
	User-defined messages
	Block states (e.g. Level mute)
	Output Contacts
	Flip-flops
Gain control	Input Voltage mapping
	DMX value mapping

When good sound and easy setup matter: HARVEY



Conference rooms



Theme parks



Theaters



Town halls



Museums



Hotels



www.harvey.audio



CONTACT

DSPECIALISTS
Digitale Audio- und Messsysteme GmbH
Helmholtzstraße 2 – 9L
10587 Berlin
Germany

Tel: +49 30 467 805 - 0
Fax: +49 30 467 805 - 99

sales@dspecialists.de
www.dspecialists.de

*HARVEY and Hypermatrix are registered trademarks
of DSPECIALISTS GmbH.*

Presented by:

