

# Application Diagram for RTI RK1 In-wall Keypads



It's Under Control®

RK1 in-wall keypads are a cost effective solution for simple, intuitive multi-zone control. Used as a standalone product, RK1 series keypads are capable of transmitting infrared commands directly to source equipment. Used as part of an RTI control system, RK1 series keypads are capable of advanced control functions which include infrared routing, video/voltage sensing, relay control, and RS-232 control. The diagram below illustrates how RK1 keypads can provide intuitive control of volume, source selection, and even lighting.

Two RK1 keypads can be connected together in a master/slave configuration, for additional control capability. The keypads will automatically sync together, creating a more flexible configuration for more demanding applications.

Bring the music into the kitchen with the simple, intuitive interface of the RK1-4. Choose from over 100 keycap labels to truly customize the keypad to meet almost any control demand. This RK1-4 keypad allows for simple on/off control of the kitchen zone, as well as volume control. Buttons can do a simple command with a button press, as well as be programmed to execute alternate commands when you press and hold or double tap a button. (Ex: Holding "ON" will change the current audio source)



RK1-2

RK1-8

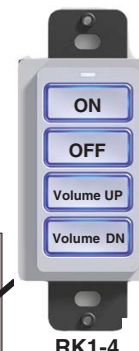
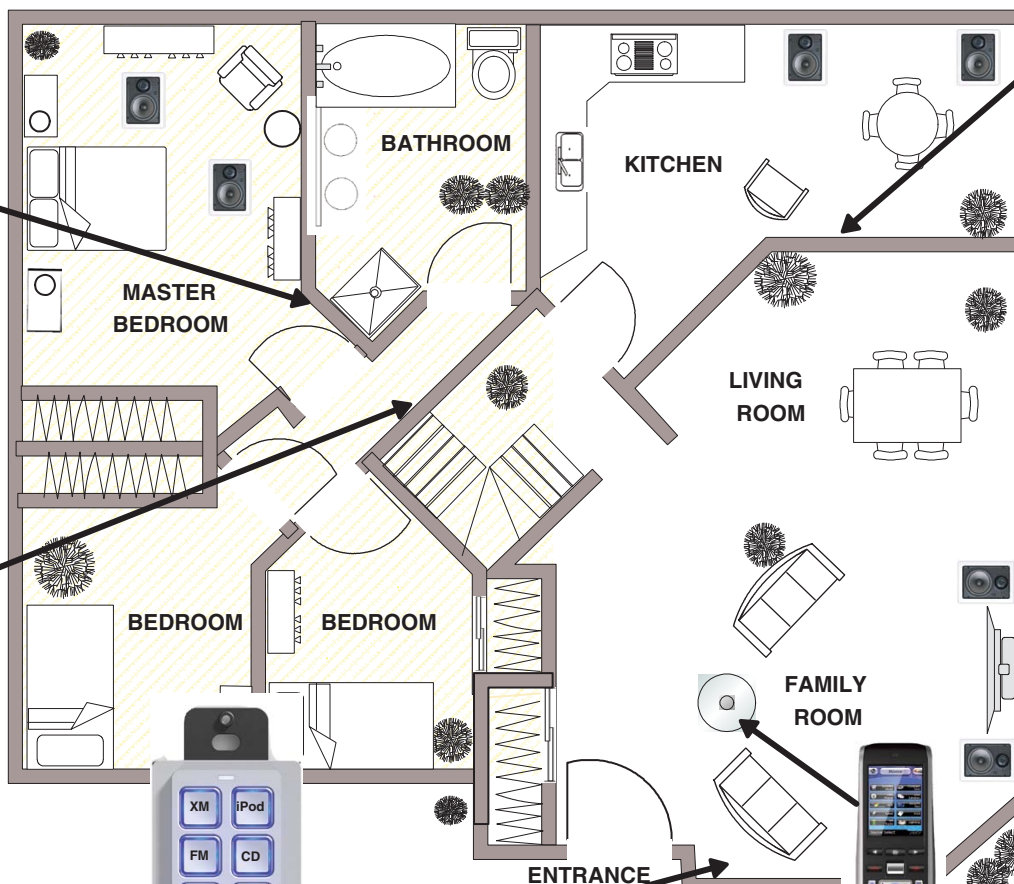

RK1-4



RK1-2

RK1 keypads can even control motorized shades and drapes. When used in conjunction with an RTI central processor, the 2, 4, and 8 button keypads have the ability to control devices through 12V triggers or contract closure.

RK1 Series Keypads can integrate with any infrared or RS-232 controllable (when used with RTI central processor) lighting system. Set the perfect lighting level for any location easily with the RK1.



RK1-4

Upon entering the front door, access to favorite songs, stations, and playlists is just a button press away. Press any of the top four buttons to select the desired source. (FM, iPod, XM, CD) The RK1 series keypad can even change the backlight color of individual buttons to indicate which source is currently selected. Additional buttons on the entryway RK1-8 allow for volume control and channel/ song navigation.



RK1-8



T2-C Controller



**Source Equipment**



Marantz ZS5300 Multi-Zone Receiver



Polk XM Radio



iPort



Escent Fireball